



# ELECTRIC STRIPES

---

## *ABOUT*

*Electric Stripes design limited edition neon artworks that are handmade in the UK*

*The debut collection consists of Rainbow Jet, Heart Balloon and Lipstick City*

*Rainbow Jet sets a playful and warm hearted tone for the collection bringing something of the outside in*

*Lipstick City's pink and red skyscrapers bow to New York nights in high heels*

*The floating lines of Heart Balloon glow in sugar coated pastel pink*

*To view all our artworks please visit our website*

***[www.electricstripes.com](http://www.electricstripes.com)***

## *CARE*

*\*Please treat this artwork with extreme care\**

### ***Recommendations for cleaning***

*Ensure the artwork is switched off before cleaning*

*Use a dry cloth to clean the glass tubing*

*Spray a small amount of anti static cleaner onto a dry lint free cloth to clean the perspex (anti static spray can be purchased online or the high street)*

*This artwork is designed to be plugged into a 3 pin mains socket and should not be hard wired into the electricity supply*

*When switched on this artwork uses the equivalent of a 60 watt light bulb*

*If used everyday the lifespan is approximately 10 years*

***[www.electricstripes.com](http://www.electricstripes.com)***

# HANGING INSTRUCTIONS

---

*Screws and rawl plugs for fixing the piece to the wall are included  
and are suitable for a brick wall*

*When hanging ensure that a plug socket is nearby*

1.

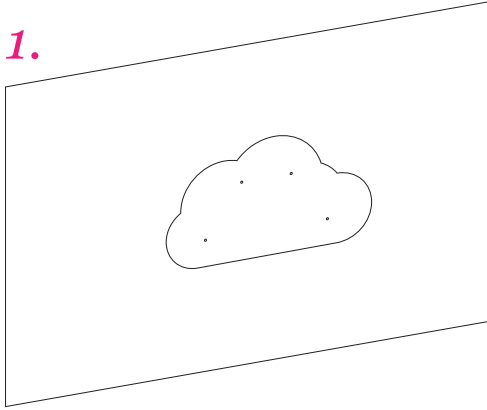

*Use blu tack or tape to place template on wall  
ensure template is straight using a spirit level*

2.

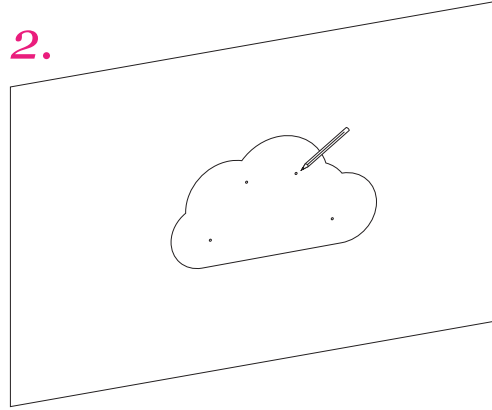

*Mark out screw holes on the wall*

3.

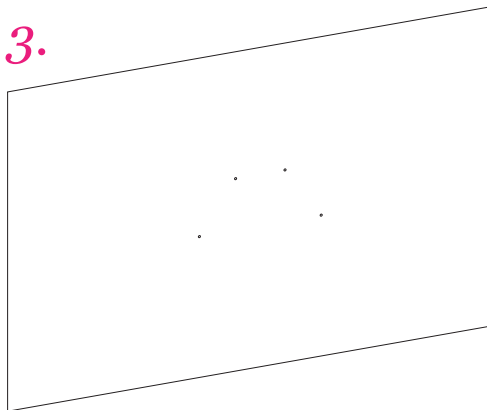

*Drill holes big enough to fit rawl plugs*

4.

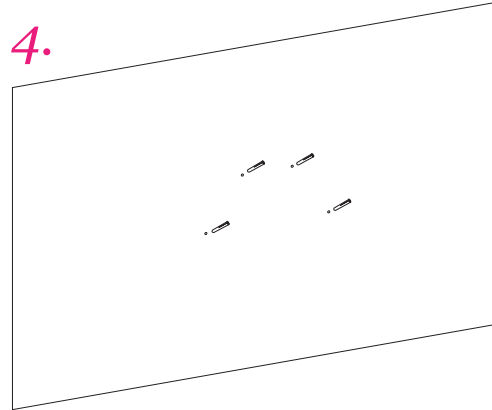

*Insert rawl plugs into holes*

5.

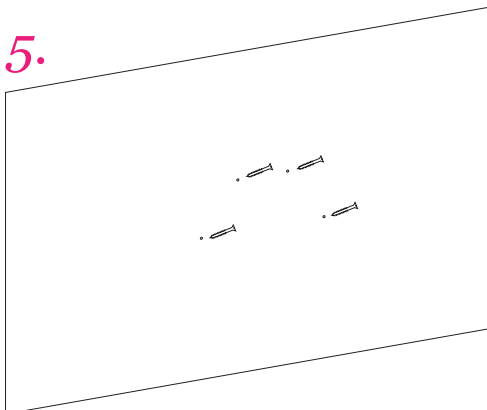

*Place screws into rawl plugs leaving 1cm of  
screw out*

6.

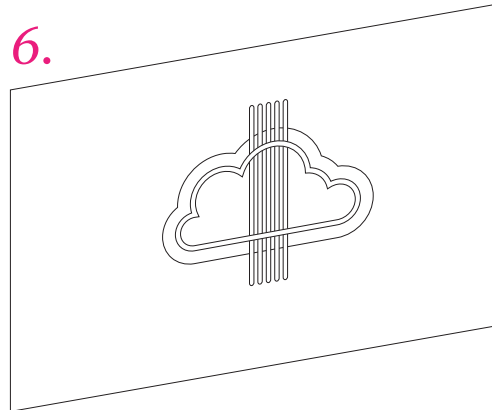

*Mount piece on the screws ensuring all 4  
brackets are secure*